

Subsea link

SP's Subsea link (SL) has been manufactured for use in subsea or submersible projects where accurate load monitoring is required.

Constructed from 17-4PH stainless steel with o'ring seals and moulded SubConn connector the SL link design ensures high integrity and will resist saltwater, temperature variations and the water pressure at varying depths of up to 2000m or 6562 feet.

At depth the SL can be handled and rigged via an ROV where it maybe inaccessible by a diver/s or cost may prohibit.

Output options include mV/V to the SP Handheld plus, 4-20mA or 0-10v analog to a PLC, Datalogger or The Multi Operation Survey System (MOSS), RS485 or an integral datalogger storing up to one million readings and powered by an internal battery.

Designed to accept Crosby ROV shackles - additionally there is an option for ROV mounting on the SL body itself.

Features and benefits:

- On board data-logging option
- Pressure tested to depth of 2000m/6562ft
- SubConn connector
- Environmental protection IP68/NEMA6P
- mV/V, 4-20mA, 0-10v, RS485 output options
- 17-4 Stainless Steel
- Designed to fit with Crosby ROV shackles

Applications:

- Offshore platforms
- Ships and towing cables
- Aquaculture
- Subsea structure lifting systems
- ROV exploration
- Umbilical load monitoring
- Oceanography or navigation projects
- Renewable energy platforms

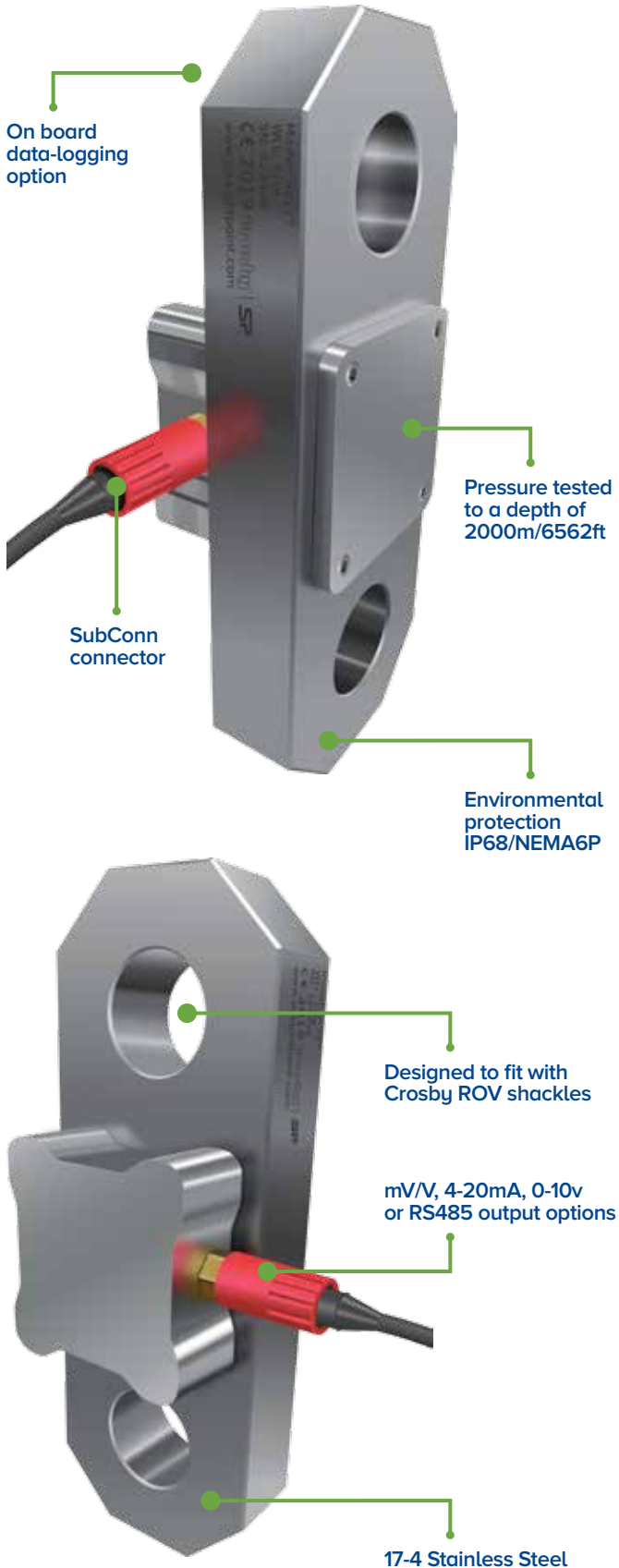

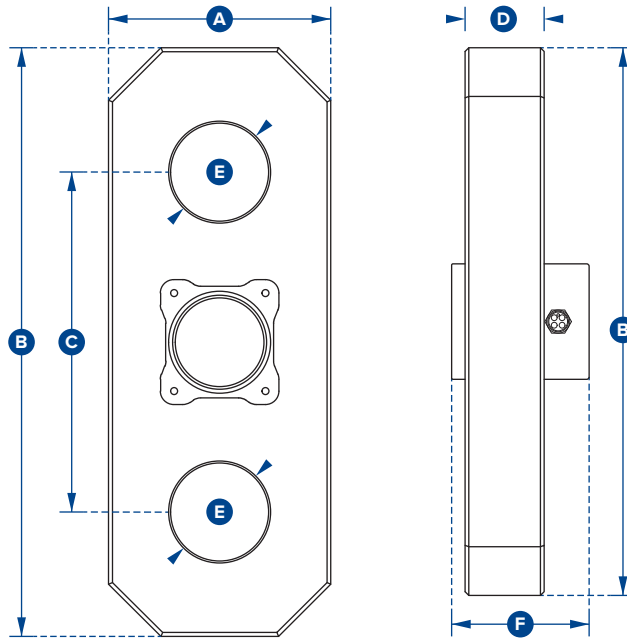

Part Numbers	SL6T5	SL12T	SL25T	SL35T	SL55T	SL85T	SL120T
SP	2789352	2789353	2789354	2789355	2789356	2789357	2789358
WLL	6.5te 14300lb	12te 26000lb	25te 55000lb	35te 77000lb	55te 120000lb	85te 185000lb	120te 260000lb
Weight	7kg 15lb	10kg 23lb	16kg 34lb	22kg 49lb	34kg 75lb	46kg 101lb	67kg 148lb
Safety Factor	5:1						
Output	Options for: mV/V / 4-20mA / 0-10v / RS485 or internal data logger						
Operating Temp	-10°C to +50°C / 14°F to 122°F						
Accuracy	±0.1% of full scale						
Max depth of use	2000 metres / 6562 feet						
Material	17-4 PH Stainless steel						
MTBF to WLL	Typically 50 million cycles						
Elongation	Typically <0.4mm / at WLL						
Dimension A	95 3.74"	100 3.94"	130 5.12"	150 5.91"	168 6.69"	190 7.48"	220 8.66"
Dimension B	240 9.45"	300 11.81"	350 13.78"	400 15.75"	450 17.72"	490 19.29"	550 21.65"
Dimension C	180 7.09"	200 7.87"	230 9.06"	250 9.84"	260 10.24"	290 11.42"	335 13.19"
Dimension D	25 0.98"	40 1.57"	45 1.77"	50 1.97"	65 2.56"	75 2.95"	86 3.39"
Dimension ØE	30 1.18"	40 1.57"	55 2.17"	60 2.36"	75 2.95"	88 3.46"	100 3.94"
Dimension F	73 2.87"	88 3.46"	93 3.66"	98 3.86"	113 4.45"	123 4.84"	134 5.28"
Crosby Shackle	G2140 or G2100 or G2110 ROV shackles						

Datalogger Measurement Rate	Days
1 per second	10
1 per 30 seconds	57
1 per minute	729
1 per 2 minutes	1445
1 per 30 minutes	3423
1 per hour	3600
1 per 2 hours	3694
1 per 8 hours	3769