

Running Line Dynamometer

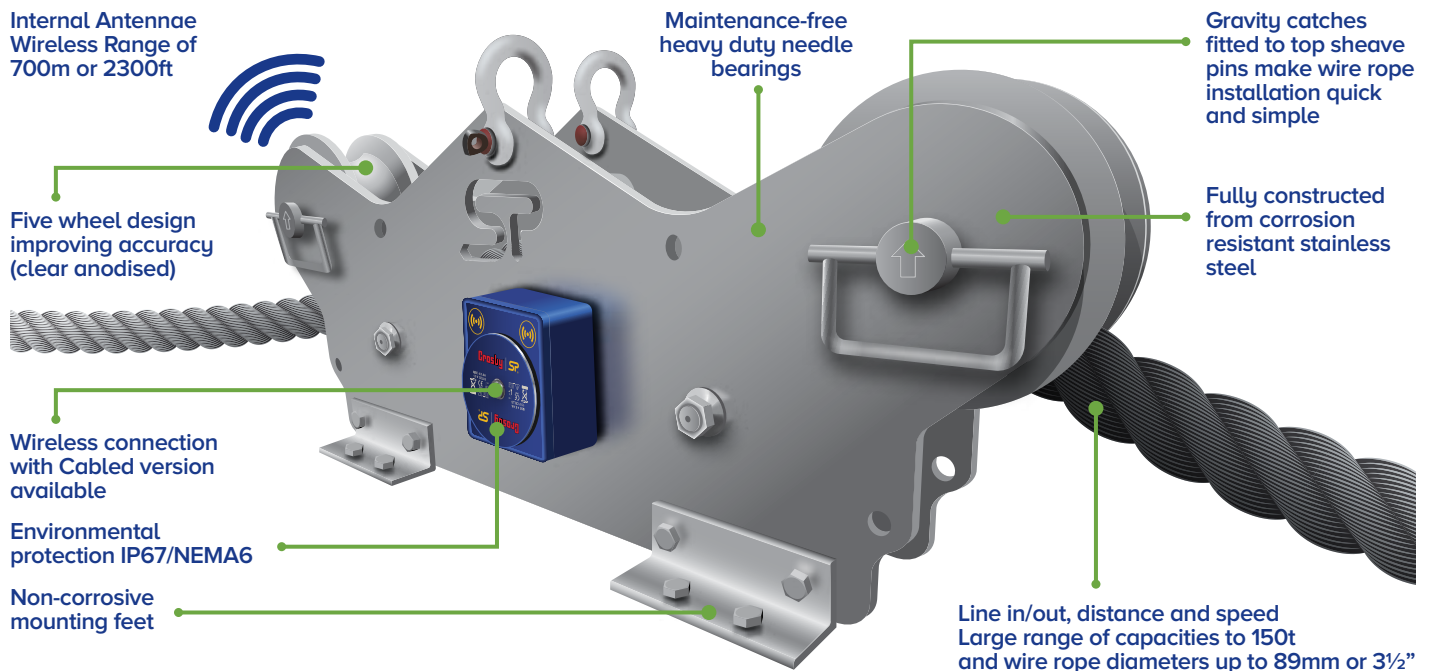

The TIMH range is a Running Line Tensiometer, or RLTM, built with dockside, marine, offshore, towage and salvage applications in mind.

It is particularly useful where there is no anchor or dead end on the line to rig a Straightpoint Radiolink or Loadlink digital dynamometer. The TIMH can measure tension force at speeds up to 20m/min or 65ft/min.

It is constructed from marine-grade stainless steel and is suitable for many wire rope configurations up to 80t and will, as an option, calculate lineout in metres or feet.

The TIMH has several mounting points featured in its unique design, however, if other mounting options are required, Straightpoint can provide a custom engineered solution specific to your application.

Available as a wireless or cabled system utilising Straightpoint's HHP range of handheld displays or SW-MWLC software, this impressive Running Line Dynamometer or RLTM is available to ship from stock, to anywhere in the world within days.

Features and benefits:

- Five-wheel design improving accuracy
- Cabled or wireless options
- Fully constructed from corrosion-resistant stainless steel
- IP67/NEMA6 Loadpin
- Gravity catches fitted to top sheave pins make wire rope installation quick and simple
- Industry leading battery life of 1200hrs (wireless)
- Maintenance free heavy duty bearings
- Large range of capacities to 150t and wire rope diameters up to 89mm/3½"
- Options for line out available
- Software available to data log and monitor or analogue outputs
- Design validated by F.E.A.
- Bluetooth option is available and is supplied with a free HHP App for iOS and Android

Also available with hazardous area approval. Zones 0, 1 & 2



ATEX / IECEx

Ex ia II C T4 Ga

Certification numbers:

TIMH ATEX

IECEx SIR 16.0041X / Sira 16ATEX2108X

SW-HHP ATEX

IECEx SIR 15.0072X / Sira 15ATEX2196X

**Add 'ATEX' to the part number
when ordering ATEX/IECEx products.
For example: TIMH10T-ATEX**

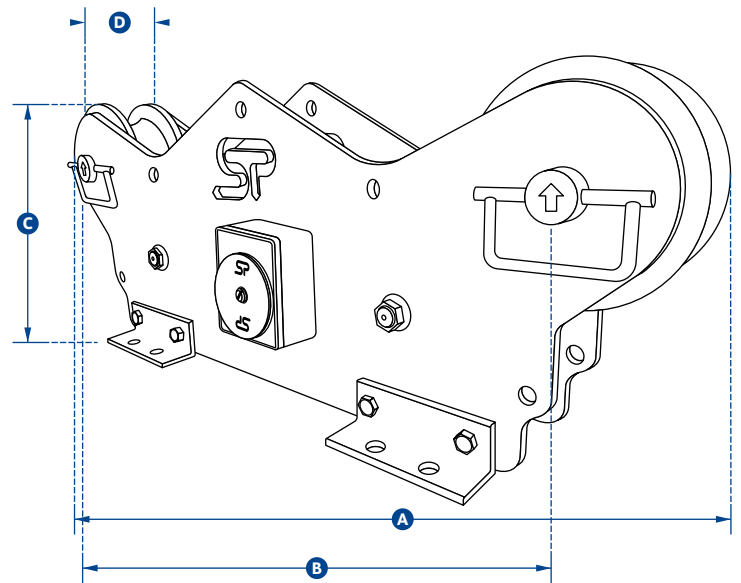

| Part Number | MTIMH10T | TIMH10T | TIMH25T | TIMH56T | TIMH80T | TIMH150T |
|----------------|---|------------------------|----------------------|----------------------------|------------------------|------------------------|
| Capacity | 10te 22000lb | 10te 22000lb | 25te 55000lb | 56te 123200lb | 80te 176000lb | 150te 330000lb |
| Resolution | 0.01te 20lb | 0.01te 20lb | 0.02te 50lb | 0.05te 100lb | 0.1te 200lb | 0.2te 500lb |
| Wire Rope Ø | 4-19mm 5/32" - 3/4" | 13-19mm 1/2" - 3/4" | 16-26mm 5/8" - 1" | 28-38mm 1 1/8" - 1 1/2" | 40-52mm 1 5/8" - 2" | 52-89mm 2" - 3 1/2" |
| Weight | 9kg 20lb | 90kg 198lb | 86kg 190lb | 81kg 179lb | 76kg 168lb | 230kg 506lb |
| Battery Type | 4 x AA Alkaline | | | | | |
| Battery Life | 1200hrs continuous (500hrs if Bluetooth) | | | | | |
| Operating Temp | -10°C to +50°C / 14°F to 122°F | | | | | |
| Accuracy | ±2% of full scale | | | | | |
| Frequency | 2.4 GHz | | | | | |
| System Range | 700 metres / 2300 feet (100 metres / 328 feet if Bluetooth) | | | | | |
| Data Rate | 3 updates per second | | | | | |
| Protection | IP67/NEMA6 | | | | | |
| Maximum Speed | 20m per minute / 65ft per minute | | | | | |
| Dimension A | 422mm 16.62" | 880mm 34.65" | | | | 1250mm 49.21" |
| Dimension B | 330mm 13" | 700mm 27.55" | | | | 1050mm 41.33" |
| Dimension C | 152mm 5.98" | 330mm 12.99" | | | | 416mm 16.37" |
| Dimension D | 36mm 1.4" | 110mm 4.33" | | | | 153mm 6.02" |